



59 OAKHANGER DRIVE,
LAWRENCE WESTON, BS11 0RJ

**GOODMAN
& LILLEY**



THIS SPACIOUS THREE BEDROOM END TERRACED HOUSE IS VERY WELL PRESENTED THROUGHOUT AND BENEFITS FROM THE THIRD BEDROOM BEING LARGE ENOUGH TO ACCOMMODATE A DOUBLE BED. THE PROPERTY ALSO OFFERS A GENEROUS REAR GARDEN AND IS OFFERED WITH NO ONWARD CHAIN. SITUATED IN A VERY CONVENIENT LOCATION JUST ROUND THE CORNER TO THE NEW LIDL STORE AND RIDINGLEAZE SHOPS AND "OUR LADY OF THE ROSARY RC SCHOOL.

Hallway

Entrance via uPVC door into hallway, stairs rising to first floor.

Lounge

uPVC double glazed bay window to front aspect, electric fire

Kitchen/Diner

uPVC double glazed window to rear aspect, uPVC double glazed window to rear aspect, uPVC door to side. Fitted with a range of wall and base units with roll top work surfaces. Stainless steel sink with mixer tap over. Electric cooker, plumbing for washing machine, combi-boiler fitted into cupboard, breakfast bar.

Landing

uPVC double glazed window to side to side aspect. Access to loft space, doors to all rooms

Bedroom 1

uPVC double glazed window to front aspect, radiator, two storage cupboards

Bedroom 2

uPVC double glazed window to rear aspect, radiator

Bedroom 3

uPVC double glazed window to front aspect, radiator

Bathroom

uPVC double glazed window to side aspect, panel bath with shower over, sink in fitted vanity unit, low level wc, heated chrome towel rail.

Gardens

There are gardens to the front and rear, the front is mainly laid to lawn, the rear has a patio area, lawned area a green house and vegetable plots

Parking

There is parking to the front

-
- No Onward Chain
 - Kitchen/Diner
 - Gas Heating
 - Gardens
 - Laing easi Form

- Three Bedrooms
- Double Glazing
- New Bathroom
- Parking
- Close to all Amenities



OFFERS IN EXCESS OF £250,000



Ground Floor

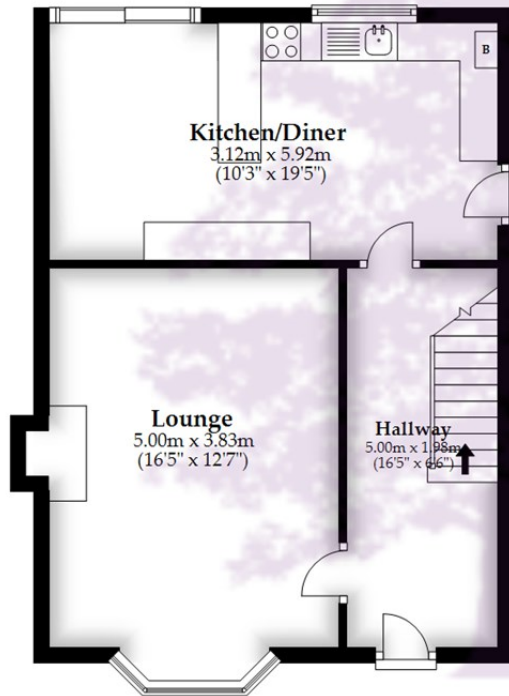

First Floor

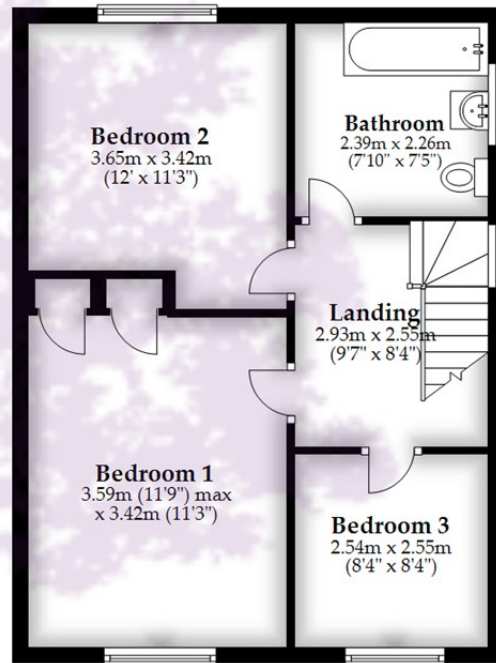

Whilst every attempt has been made to ensure accuracy of the floor plan all measurements are approximate and no responsibility is taken for any error, omission or measurement.
Plan produced using PlanUp.

HENLEAZE - 0117 2130777
henleaze@goodmanlilley.co.uk

PORTISHEAD - 01275 430440
sales@goodmanlilley.co.uk

SHIREHAMPTON - 0117 2130333
shire@goodmanlilley.co.uk

Zoopla.co.uk

rightmove



WWW.GOODMANLILLEY.CO.UK

These particulars are for general guidance only. They do not form or constitute any part of an offer or contract. Goodman & Lilley has not carried out structural surveys of the property. The services, appliances or specific fittings mentioned in these details have not been tested. Every attempt is made to ensure accuracy, however all photographs, measurements, floor plans and distances are for illustrative purposes only. They must not be relied upon when purchasing carpets and or other fixtures & fittings. Lease details, service charges and ground rents are given as a guide only. They should be checked and confirmed by a licensed solicitor prior to exchange of contracts. The copyright of all details, photographs and floor plans remain exclusive to Goodman & Lilley.